

### MOTORBIKE INHIBITOR

#### THE ASSEMBLY OVERVIEW

The two sides of this barrier can be installed at varying distances apart according to local requirements.

The closer together the two barriers are installed the more effective the structure is in deterring motorbikes. We believe that the dimensions given allow for the passage of the largest motorised wheelchairs. Before installing these barriers we suggest local disabled ramblers are consulted to establish precisely the siting and the gap that is most convenient to them.

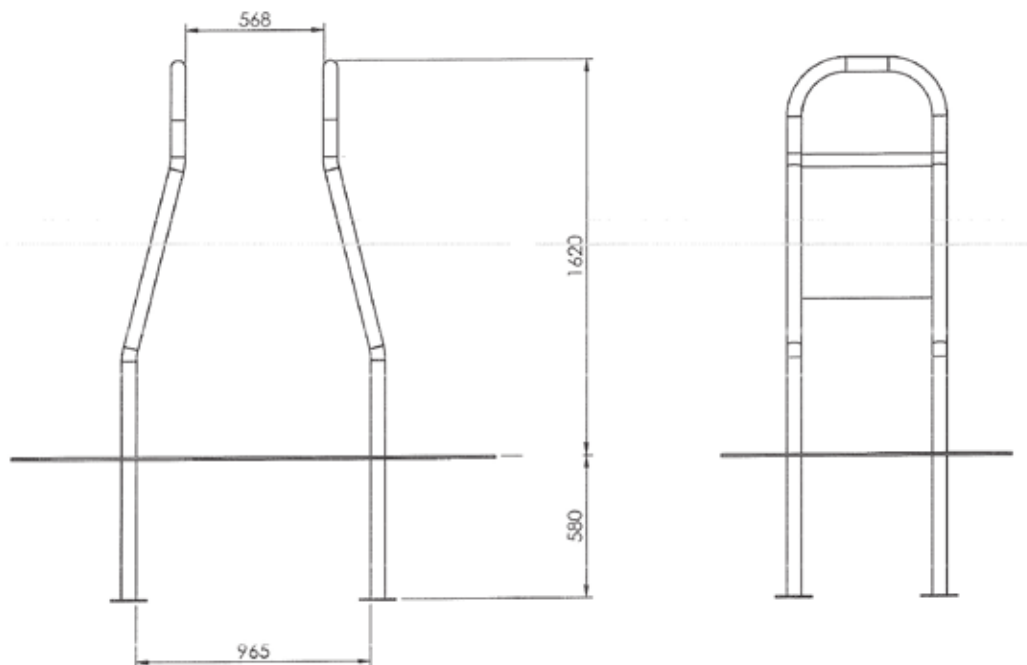

Please check that you have all the required components on site to complete the installation.

Inhibitor Panels

X 2



If you need any further advice/guidance regarding the installations of any of these products please contact the office on the number below.

Centrewire® Ltd

Mossfield Road, Adderley Green, Longton, Stoke-on-Trent, ST3 5BW

Tel: 01782 339348 Fax: 01782 339349

www.centrewire.com Email: sales@centrewire.com

Company Registration No. 1488820